



***motoalliance***

23001 Industrial Blvd, Rogers, MN 55374 / 1-866-527-7637  
www.motoalliance.com

# **MOTOALLIANCE WINCH MOUNT**

## **MA11609**

### **Polaris Sportsman**

**Thank you for purchasing our MotoAlliance winch mount(s). You now own a premium custom winch mount to allow you to use your winch with your UTV / SxS. Please note the following instructions and heed all warnings.**

- **Please use common sense when operating your UTV / SxS.**
- **Read your Winch Operator's Manual and all other Operator Manual's, including warning labels, before operating your UTV / SxS.**
- **Be observant of moving parts causing entanglement, use extreme caution!**

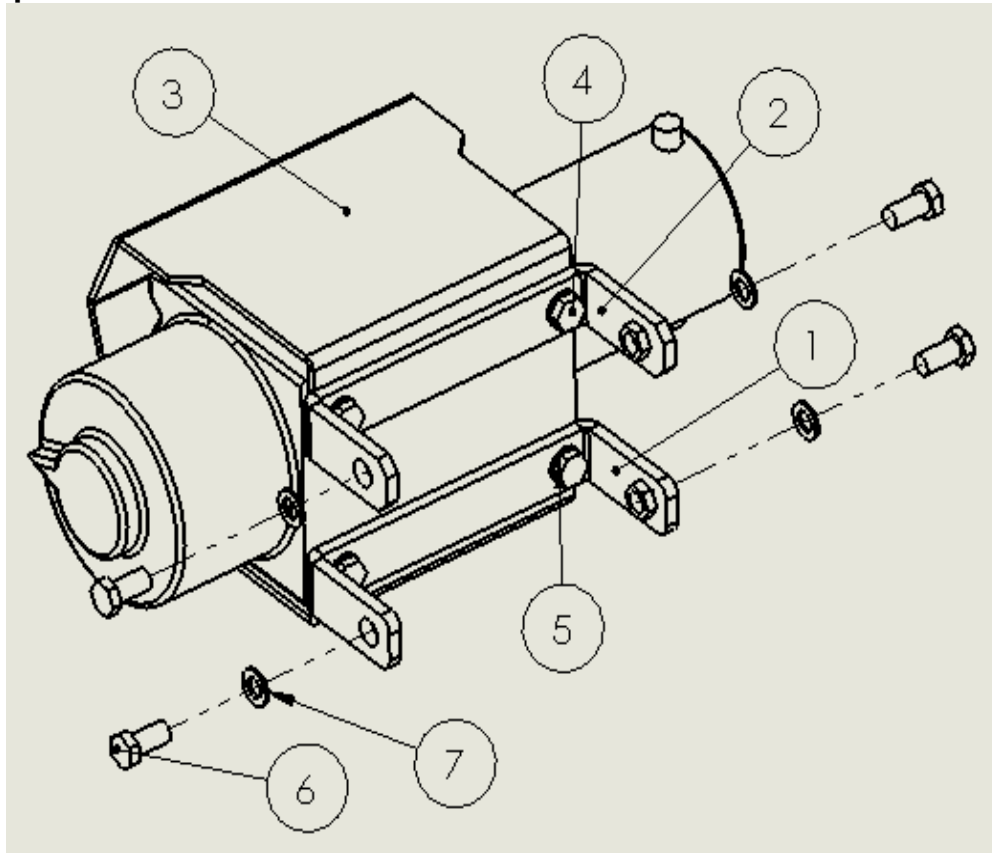
**SEVERE INJURY OR DEATH MAY RESULT IF YOU ARE NEGLIGENT.**

Please verify that all hardware and parts are included in your package.

**Kit Content:**

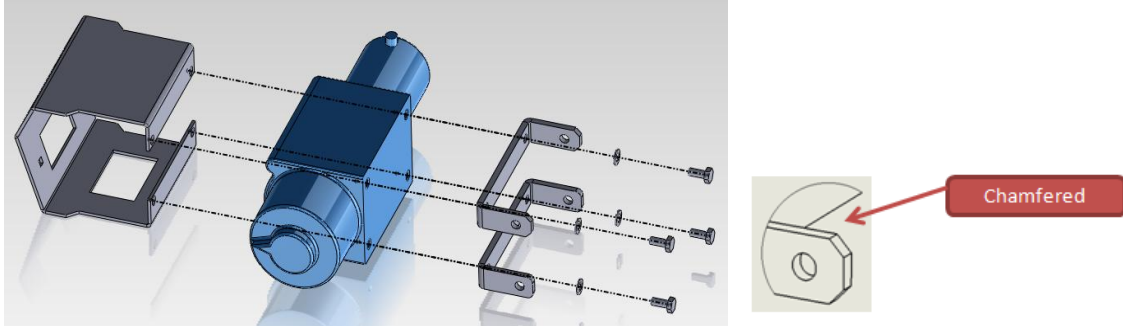
Item Number	Description	Quantity
1	Bottom Rail	1
2	Top Rail	1
3	Fairlead Mount Bracket	1
4	M8-1.25 x 25mm Bolt (In the winch kit)	4
5	M8 Washer (In the winch kit)	4
6	5/16 x 1.00 Bolt	4
7	5/16 Washer	4

**Exploded View**

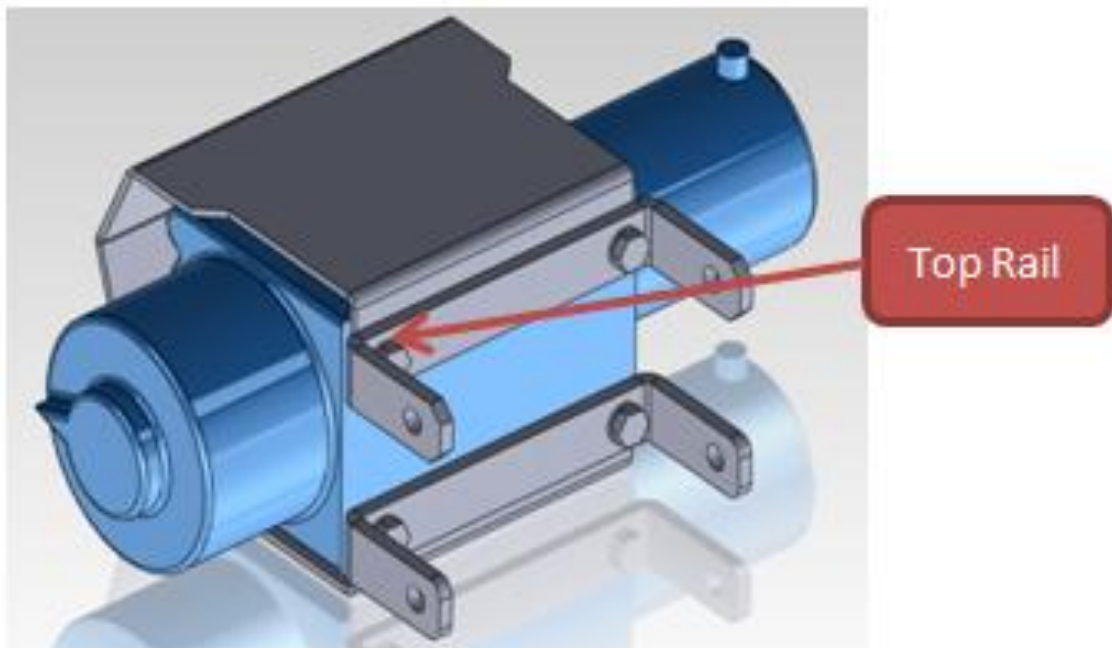


**Figure 1**

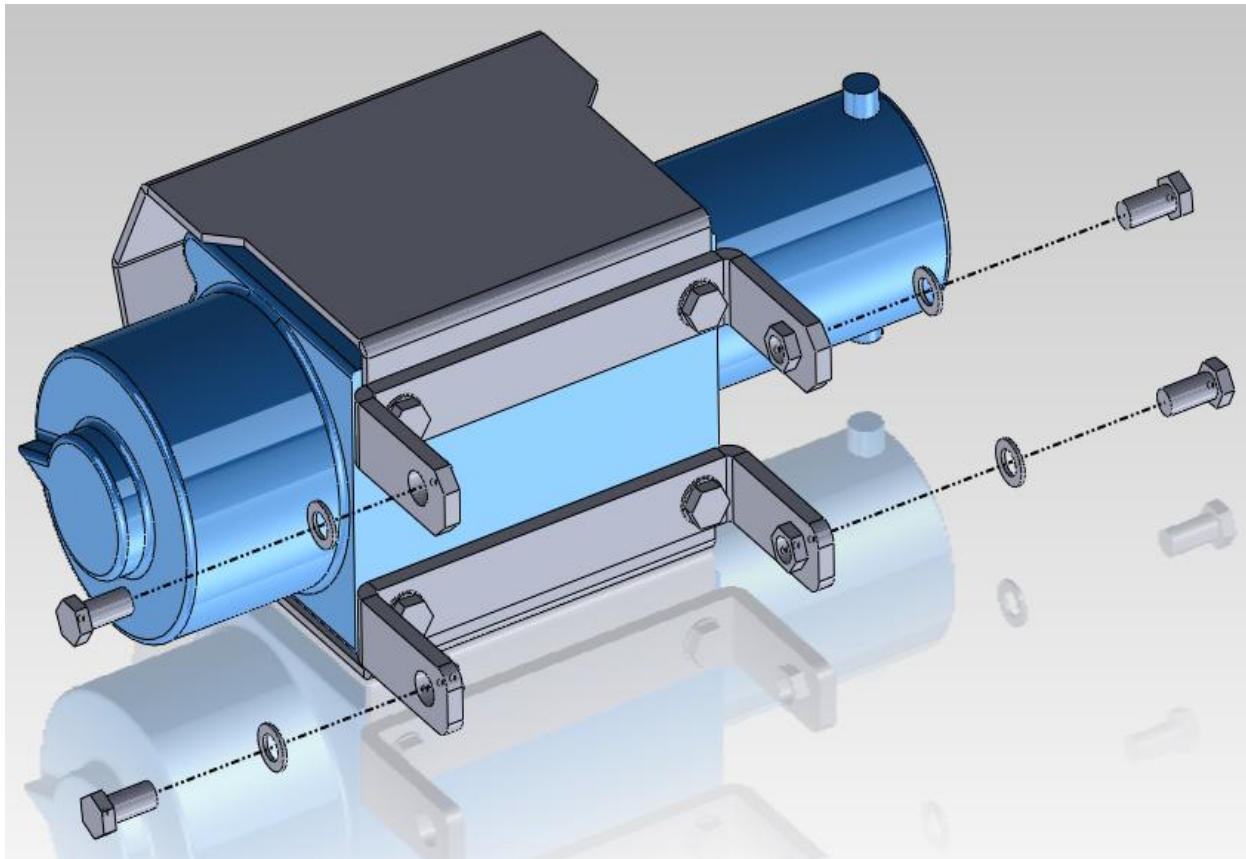
1. Assemble the Fairlead Mount Bracket, Top Rail, Bottom Rail and winch as shown  
- Note: The Top Rail is the piece with chamfered edges



2. Once assembled, pull your cable through the two tie rods such that it runs through the fairlead opening on the "top" of the winch. This may require putting the winch in freespool mode to gain additional room to work. Remove the front bumper from the Sportsman using a Torx 25 driver



3. Insert the winch between the two upright frame supports. The rail mount holes will align with four holes on the frame uprights.
4. Insert the four 5/16 bolts and tighten them into the weld nuts of the top and bottom rail



5. With the winch mount system attached to the frame securely, install contactor and wiring per included instructions. The best location for the contactor is in the

front storage unit, directly above the winch motor. Attach the contactor to the side wall using the included hardware. Remove one of the rubber plugs from the bottom of the storage unit and run the smaller wires to the winch motor. Ensure that all wires are run away from moving, abrasive, and or hot components of the vehicle. Securely attach wires with zip ties. Verify correct directional operation of the winch.



6. Attach the fairlead to the front of the fairlead bracket. Some model winches require that fairlead bolts insert from the backside of the fairlead bracket and out toward the fairlead itself.
7. Cutout the indented plastic face on the front bumper to expose the winch and fairlead. Reinstall the bumper.